

7. MAKE SURE THE DOOR IS CORRECTLY PREPPED

A 3/8" wire raceway, from hinge to the door prep, must be pre-installed inside the door.

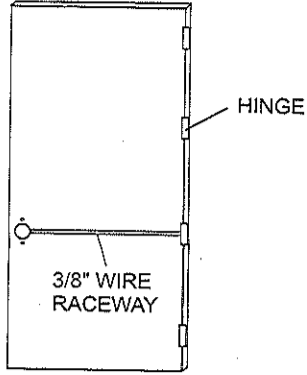

8. RUN THE WIRE THROUGH THE RACEWAY

Direct the wire through the raceway, from hinge to the door prep, and pull the wire out of the door hole.

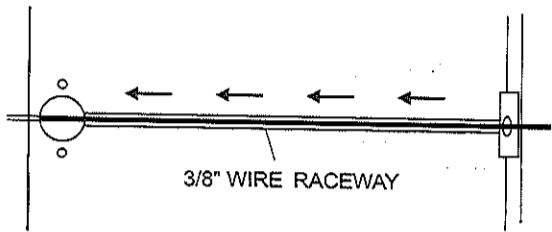

9. WIRE CONNECTION

- Connect the wire to 4 wire harnesses exiting the cylindrical lock chassis. (shown in the illustration below)
- The wire and 4 wire harnesses must be joined firmly.
- Make sure the bare wires are covered with insulating material.

For DC24V application join Blue and Black wires, then connect Red to positive and White to negative on incoming power supply.
For DC12V application join Red and Black then connect both to positive, junction White and Blue then connect both to negative on the incoming power supply.

CONDITION	Temperature 20°C	
	Resistance Tolerance +/- 10%	
Structure of the Coils	41 Ohm 	41 Ohm
Wire Connection	Series Connection 	Parallel Connection
	DC24V 80Ω ; 0.3 Amp (+/- 10%)	DC12V 20Ω ; 0.6 Amp (+/- 10%)

10. INSTALL OUTSIDE LEVER ASSEMBLY

The wires must not be crimped or pinched by the door prep, or must not be exposed outside the door prep. At the hinge end, carefully pull the wires out of the raceway and connect it to the power supply.

Install outside lever assembly on the door.

Make sure tail of latch is engaging with retractor correctly (per illustration).

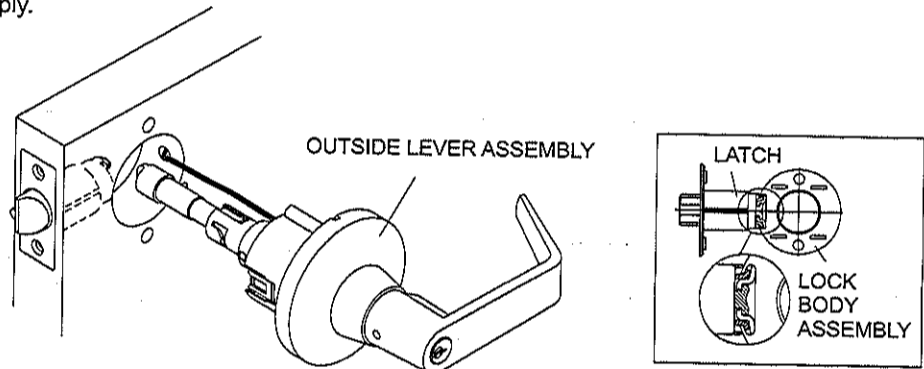

11. INSTALL INSIDE MOUNTING PLATE AND ROSE LINER

- Install inside mounting plate to lock body.
- Press inside rose liner onto mounting plate and tighten mounting screws securely.

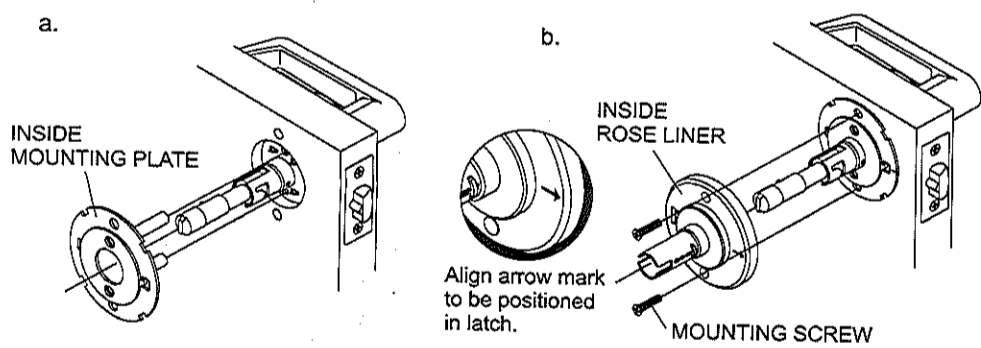

12. INSTALL INSIDE ROSE AND LEVER

- Be sure to install rose in recess of rose liner.
- Depress lever catch with tool provided. Push inside lever on completely until catch engages in lever. Confirm lever is secured.

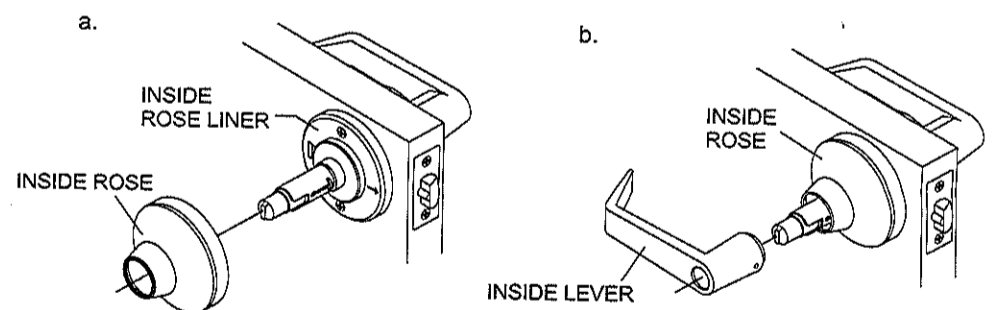

TEMPLATE

